

AIRBURST - 36" LOUVERED RECIRCULATION FAN

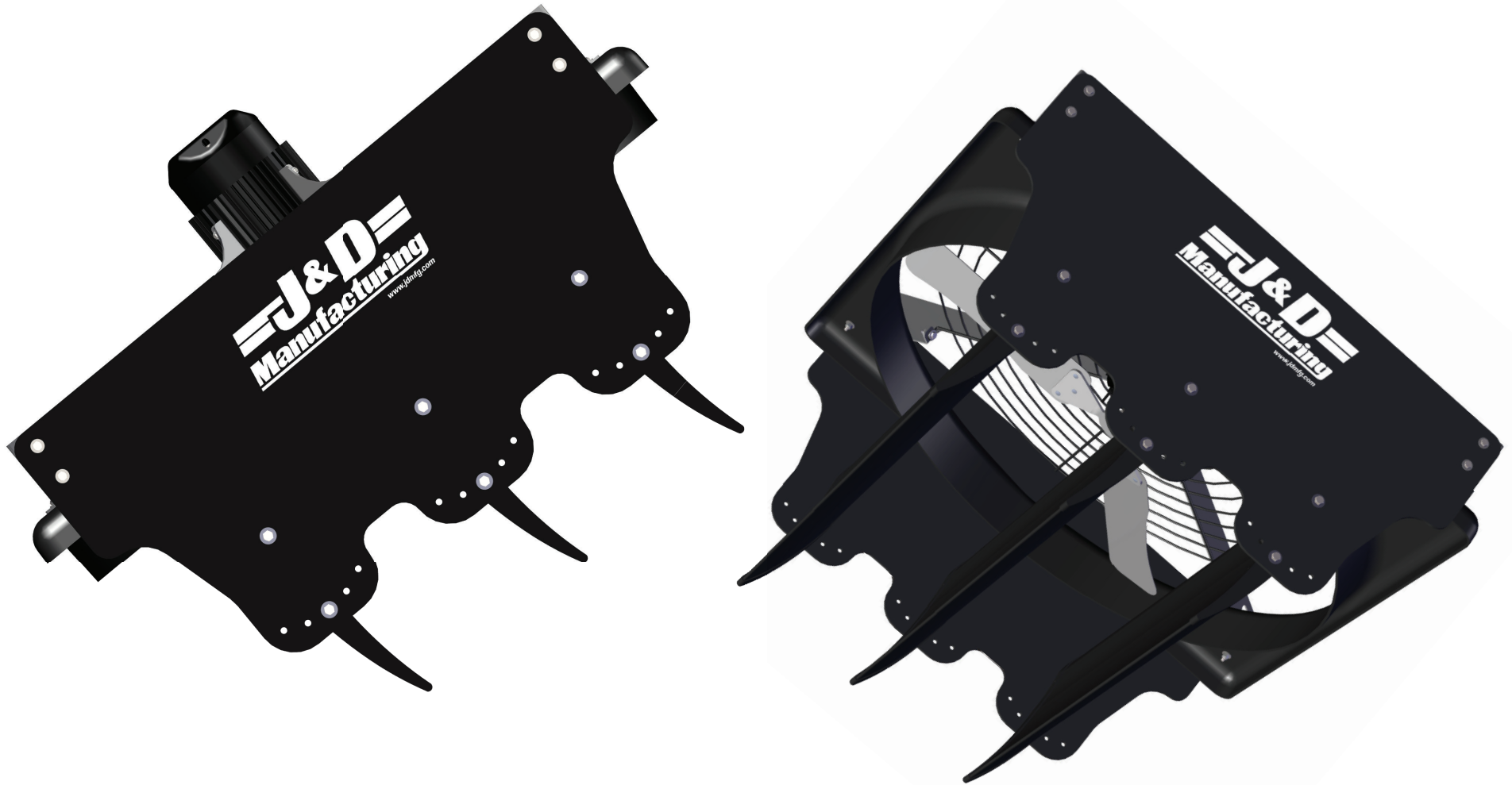

Table of Contents

Warranty	Page 2
Parts Legend	Page 3
Included Assembly Hardware For Fan	Page 3
Recommended Tools For Fan Assembly (Not Provided)	Page 3
Site and Additional Hardware Requirements	Page 3
Required Fan Orientation	Page 3
Attaching Louver Guides To Fan	Step 1
Louver Installation	Step 2
Standard Hanging Installation	
Attaching Hanging Chain Kit	Step 3
Mounting Height Recommendations	Step 4
Hanging Recommendations	Step 5
Hanging Installation With Stabilizing Chain Harness	
Trimming Chain to Make Stabilizing Chain Harness	Step 6
Stabilizing Chain Harness Assembly	Step 7
Installing Stabilizing Chain Harness to Fan	Step 8
How to use the Stabilizing Chain Harness to Hang Fan	Step 9
Mounting Height Recommendations	Step 10
Hanging Recommendations	Step 11
General Wiring Instructions	Page 10
Maintenance Instructions	Page 10
Exploded View	Page 11

WARRANTY

J&D Mfg. warrants this product is free from defects in materials and workmanship under normal use for the period of one year from date of purchase. Our warranty does not cover ordinary wear and tear. J&D Mfg can repair or replace at our option, any product or part of the product that is found to be defective. Our warranty applies to materials only and does not include return freight, delivery, loss or damage to personal property, cost of removal or installation, any incidental or consequential damages or labor. This warranty does not apply to products which are misused, abused, altered, improperly installed or subject to negligence. All warranties must be approved through our warranty department. The original purchaser must present a copy of the invoice for the defective product.

INSTALLATION

Please read over ALL instructions carefully before you begin.
If you have any questions please call your local J&D reseller,
or contact J&D Manufacturing at 1-800-998-2398.

NOTE: Instructions primarily show model with guard, there is no difference in instructions for the non-guarded model.

PARTS LEGEND

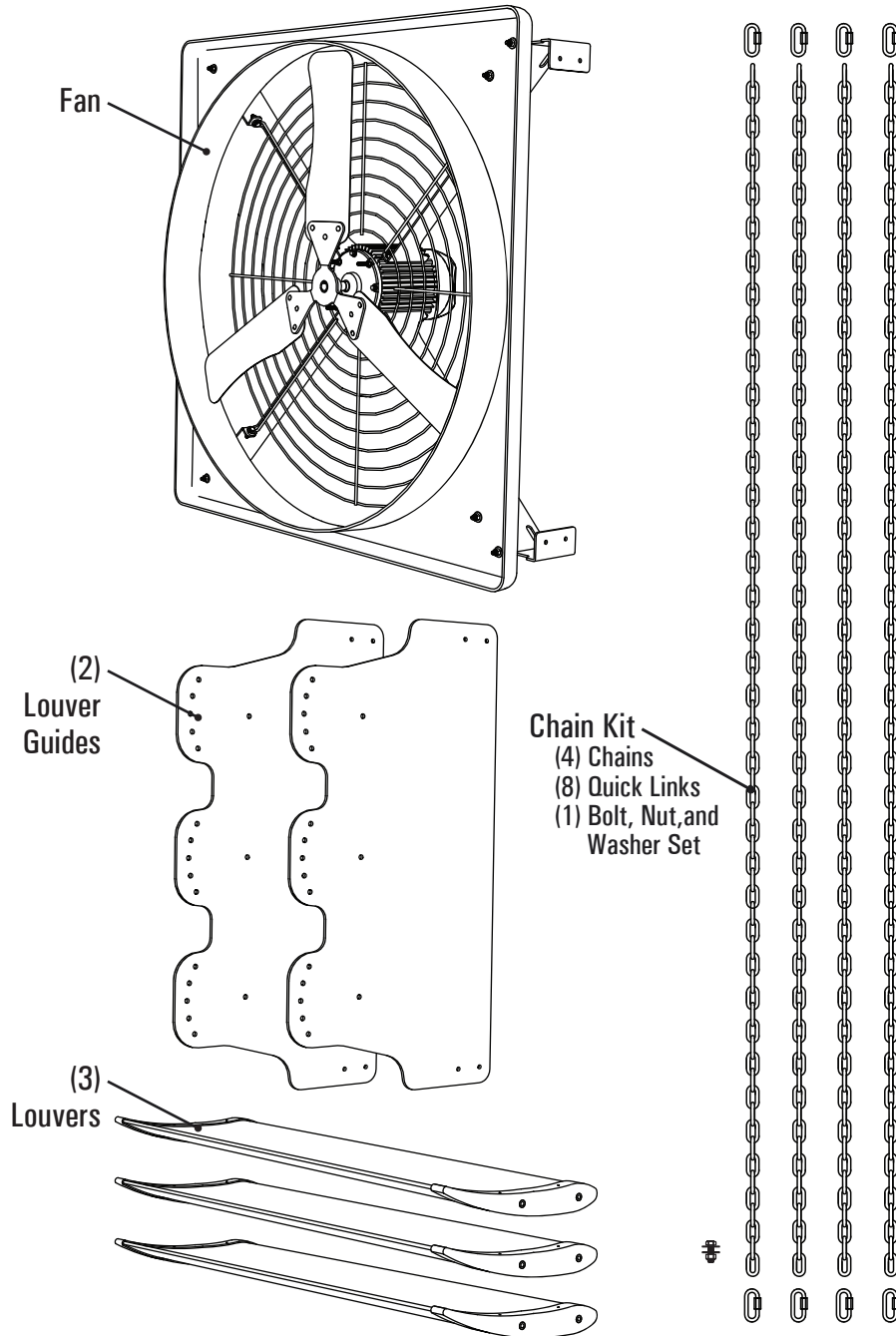

INCLUDED ASSEMBLY HARDWARE FOR FAN

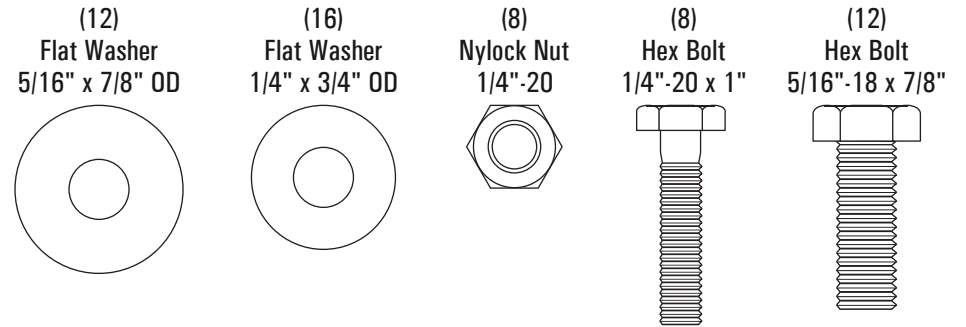

RECOMMENDED TOOLS FOR FAN ASSEMBLY (NOT PROVIDED)

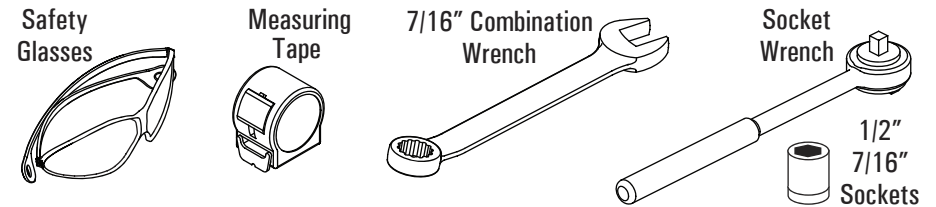

Site and Additional Hardware Requirements:

- Structure and anchor hardware (not provided) must be rated for 150lbs.

Weight 150lbs

Required Fan Orientation:

- The top or elevated part of the fan is indicated by the J&D logo on the motor.

**J&D
Manufacturing**
logo up

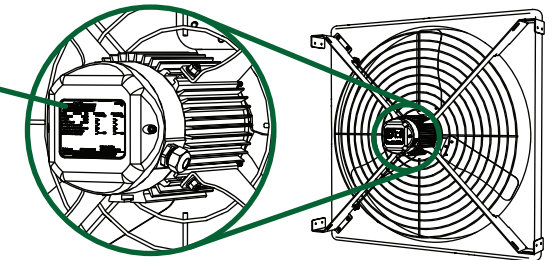

Attaching Louver Guides to Fan:

- Secure each louver guide to the fan frame using (4) 1/4"-20 x 1" Hex Bolts, (8) 1/4" x 3/4" OD Flat Washers, and (4) 1/4"-20 Nylock Nuts, as shown below.

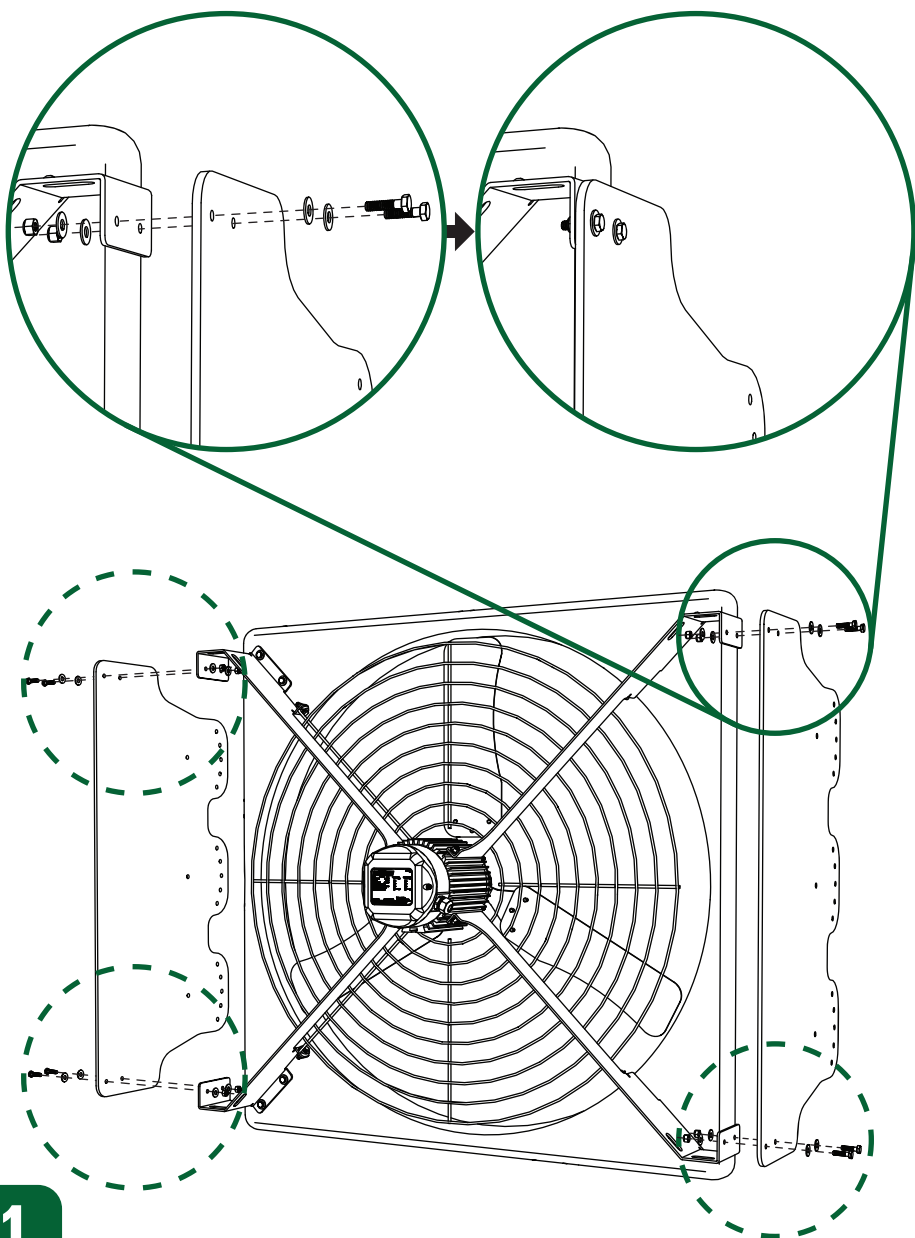

1

Louver Installation:

- Using only hand tools (**DO NOT USE IMPACT DRIVER**) secure each louver to the louver guides using (4) 5/16"-18 x 7/8" Bolts and (4) 5/16" Washers per louver, as shown below.

Use hand tools **ONLY**

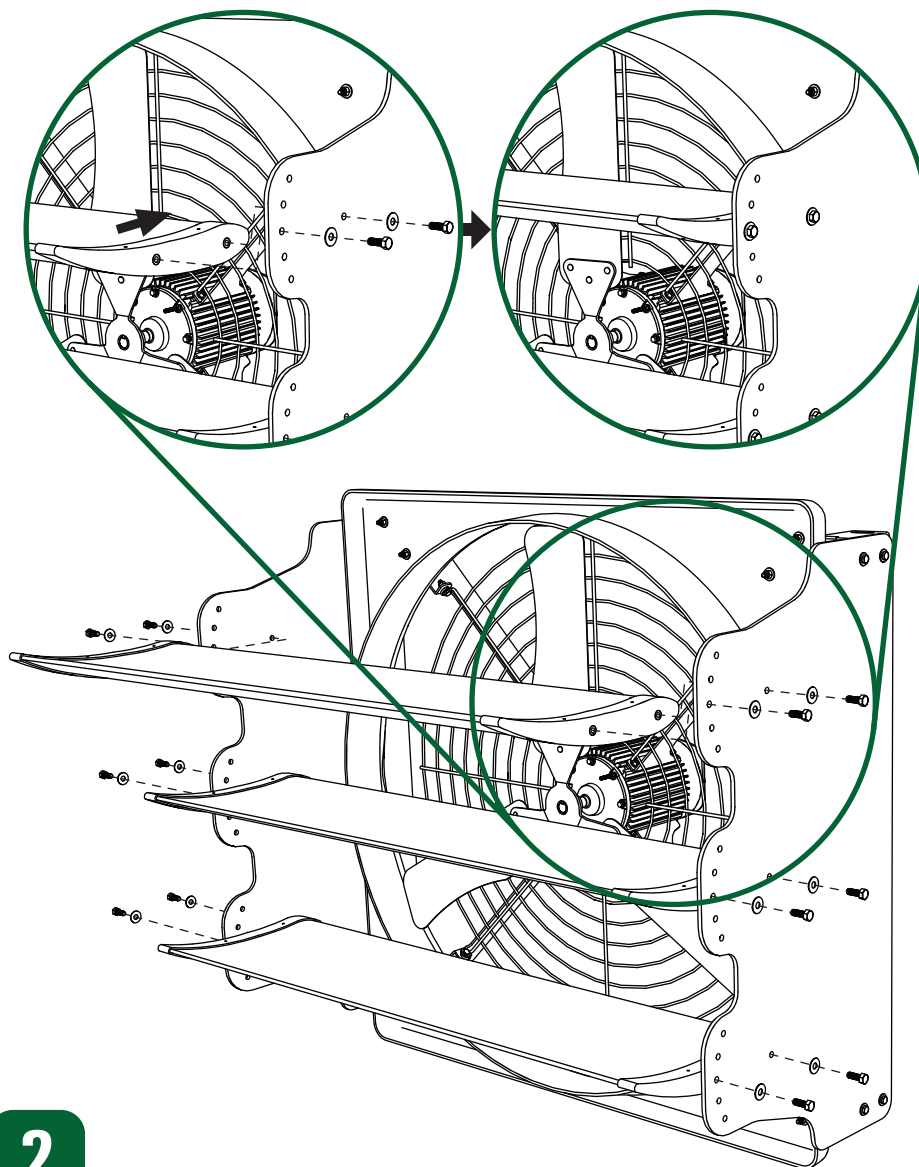

2

Before proceeding, review the chain and fan angle recommendations for hanging in Step 5.

If you are unable to meet the chain and fan angle recommendations for hanging, skip to Step 6.

If you can meet the chain and fan angle recommendations for hanging proceed to Step 3.

Attaching Hanging Chain Kit:

- Attach (1) hanging chain to each mounting bracket using (1) quick link, as shown below.
- Secure connections by fully closing each quick link by rotating the barrel until opening is closed and barrel no longer turns.

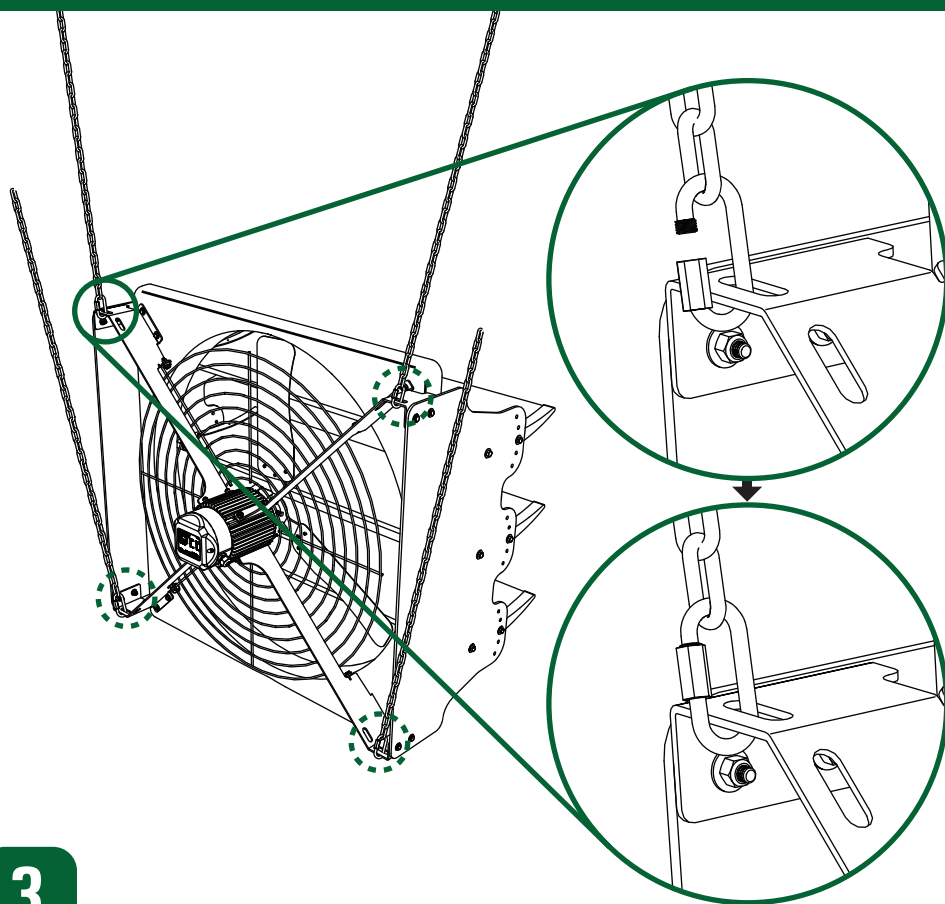

3

Mounting Height Recommendations:

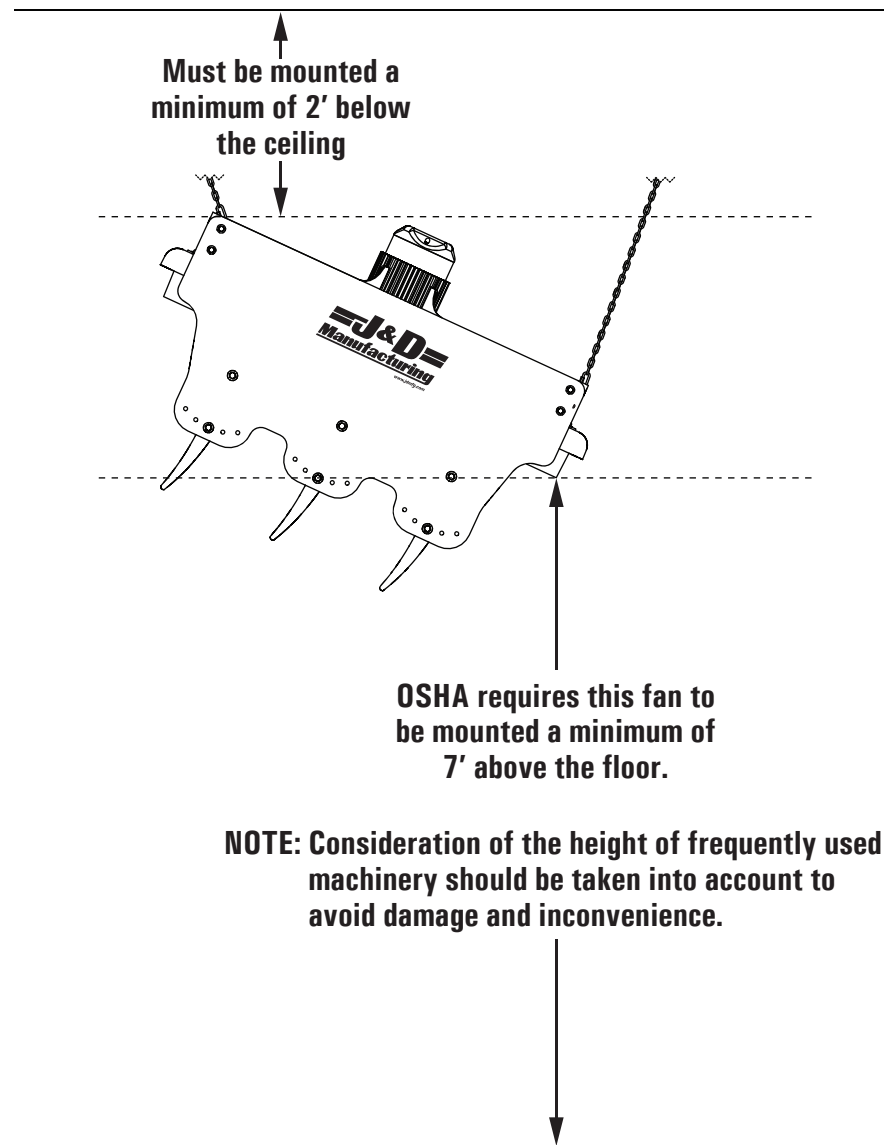

4

Hanging Recommendations:

- Take into account recommendations from **Steps 4** and the below recommended angles of the fan and chains.
- Hang fan.
- Attach each chain end to structure using (1) quick link
- Secure by fully closing each quick link by rotating the barrel as shown in **Step 3**.

NOTE: To ensure fan does not distort or twist, fan must be hung evenly and level from side to side, as shown below. If not hung correctly fan distortion may cause blade to hit venturi edge, damaging venturi and blade and will NOT BE COVERED BY WARRANTY.

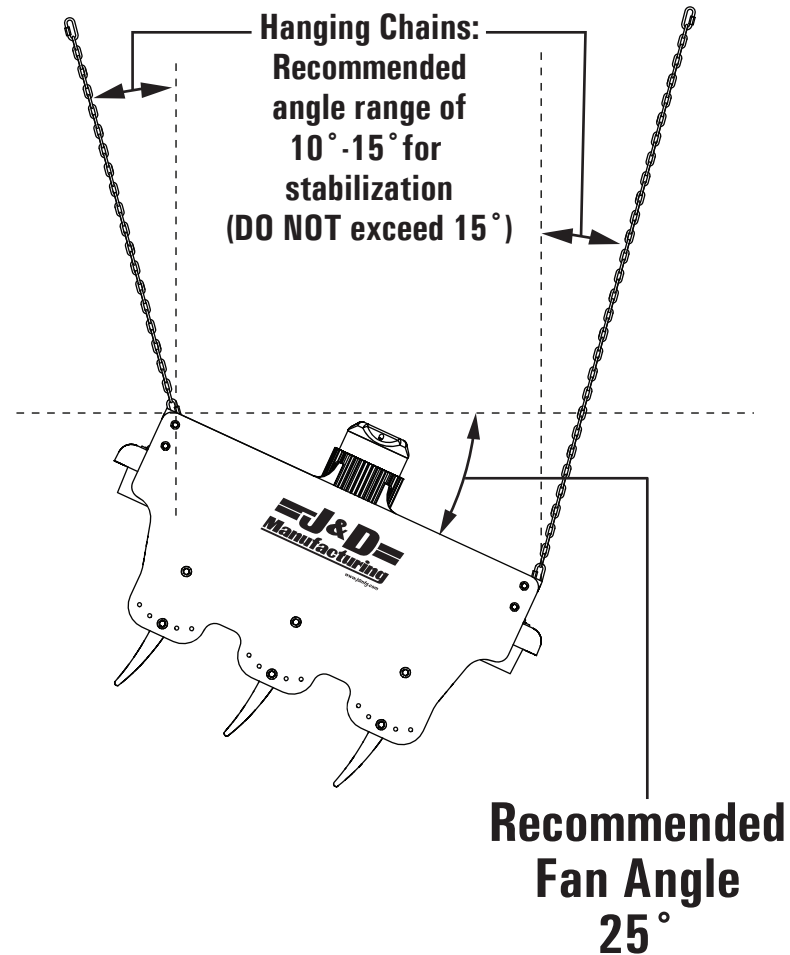
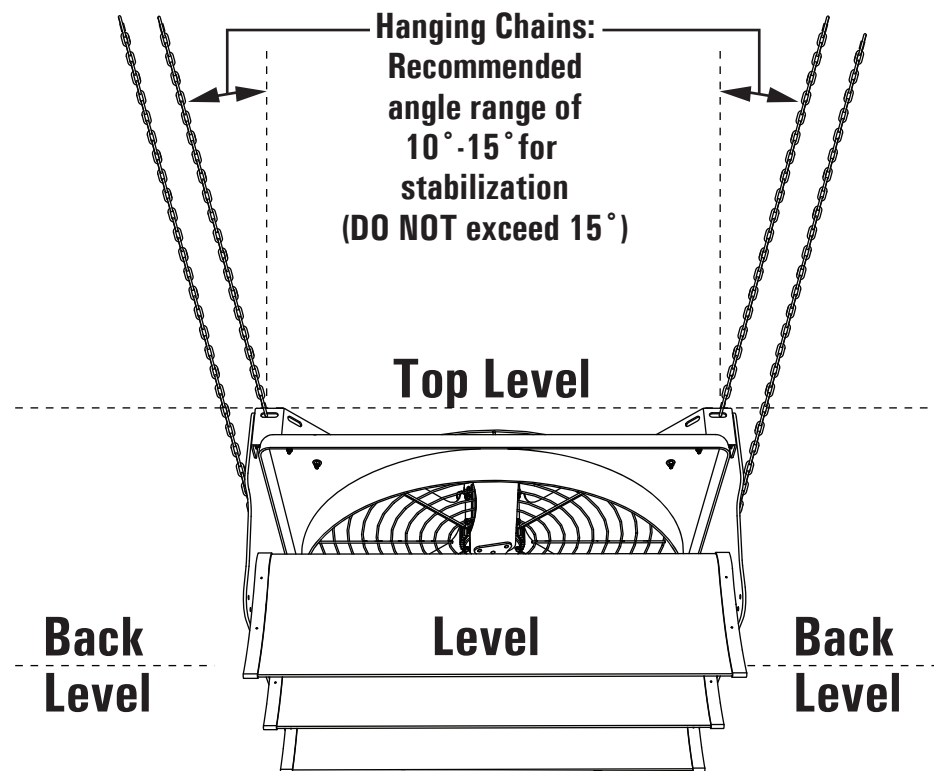

5

Once fan is securely installed skip to **Page 10**.

Trimming Chain to Make Stabilizing Chain Harness:

- Using a Bolt Cutter trim all (4) chains to 3½' in length.

6

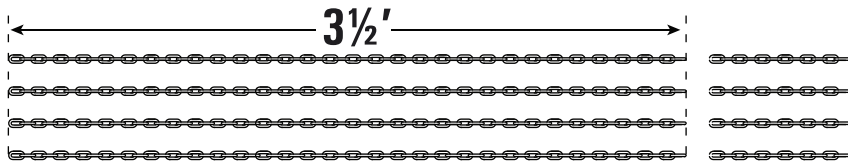

Stabilizing Chain Harness Assembly:

- Using the (1) Bolt, Nut, and Washer Set that was included with the Chain Kit, bolt together one end of each 3½' chain, as shown below.

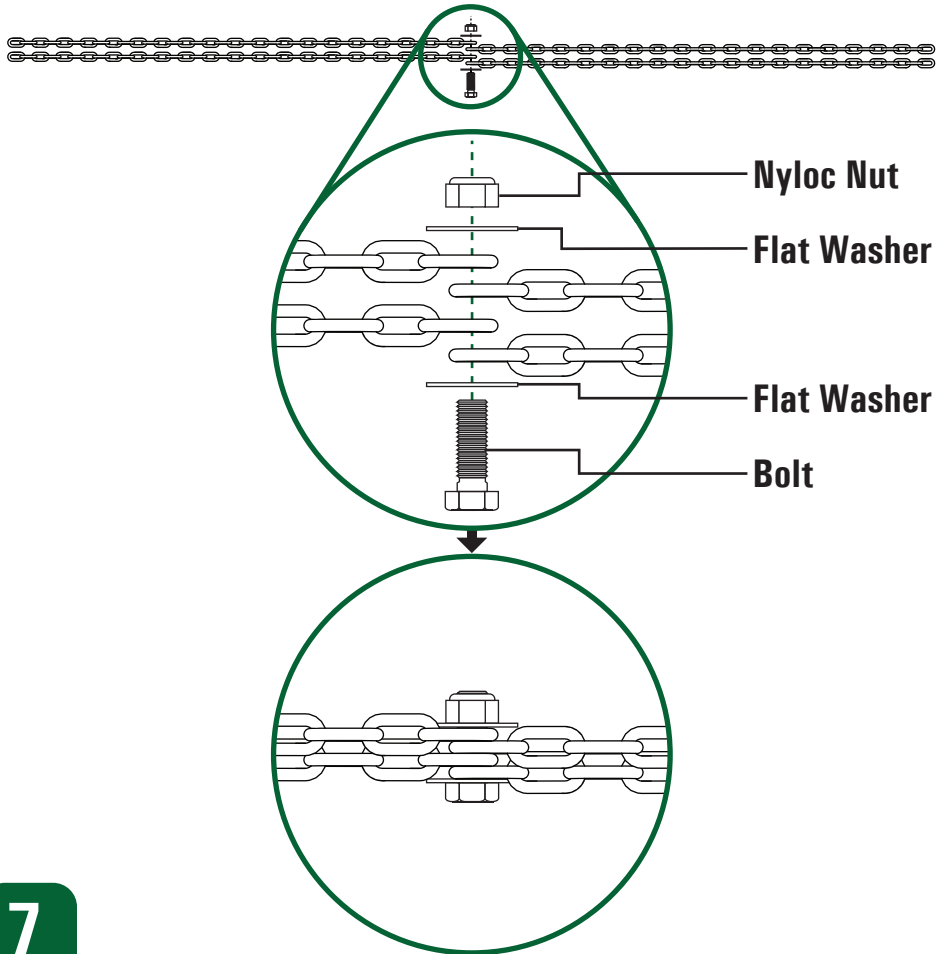

7

Installing Stabilizing Chain Harness to Fan:

- Spread out the (4) Chains into a X formation.
- Use a quick link to connect the end of each leg of the stabilizing chain harness to the fan.
- Secure connections by fully closing each quick link by rotating the barrel until opening is closed and barrel no longer turns.

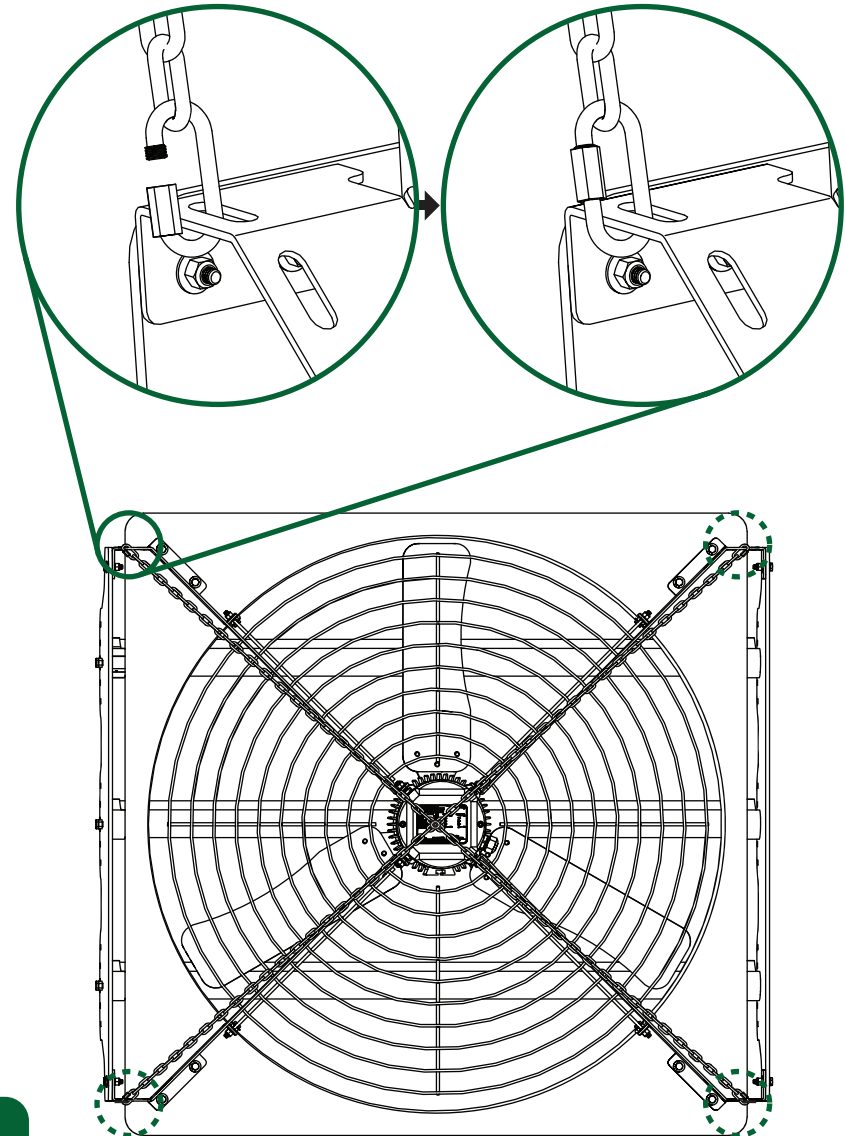

8

How to use the Stabilizing Chain Harness to Hang Fan:

- On each leg of the Stabilizing Chain Harness measure 1' from the corner and attach another quick connect, as shown below.
- These quick connects will be used to attach the hanging chains at the proper location on the Stabilizing Chain Harness.

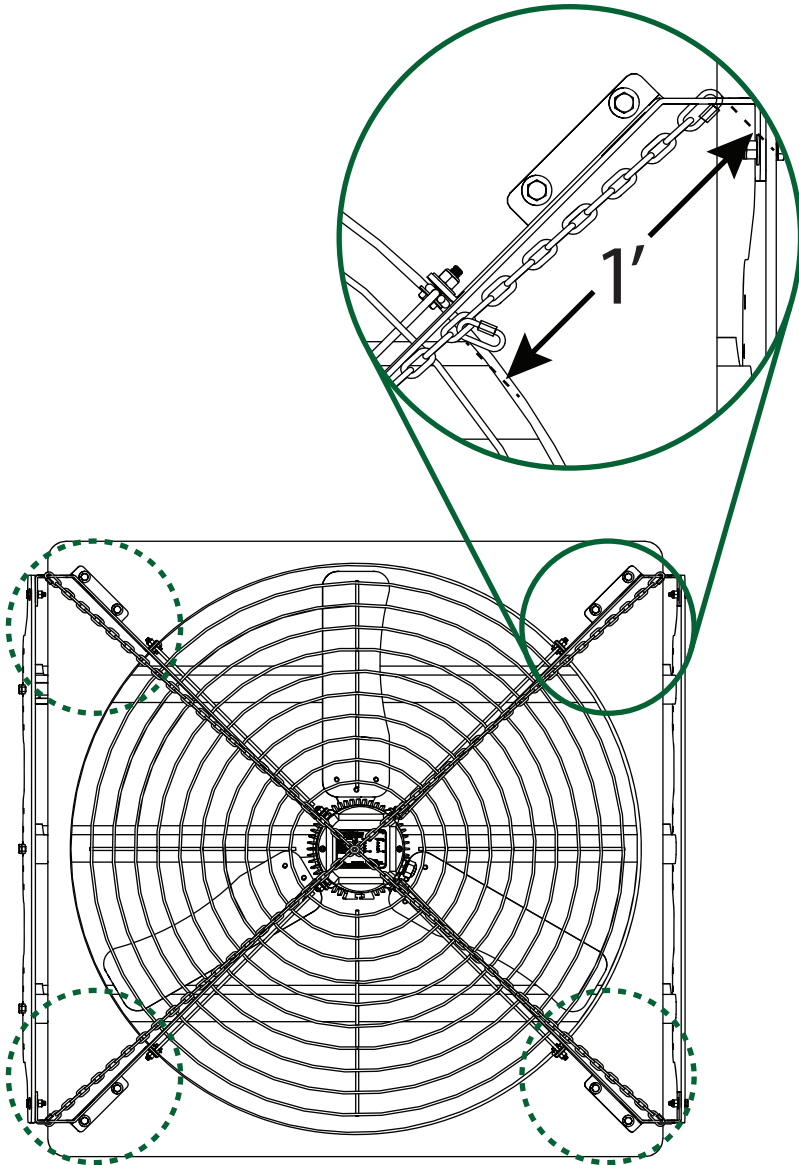

9

Mounting Height Recommendations:

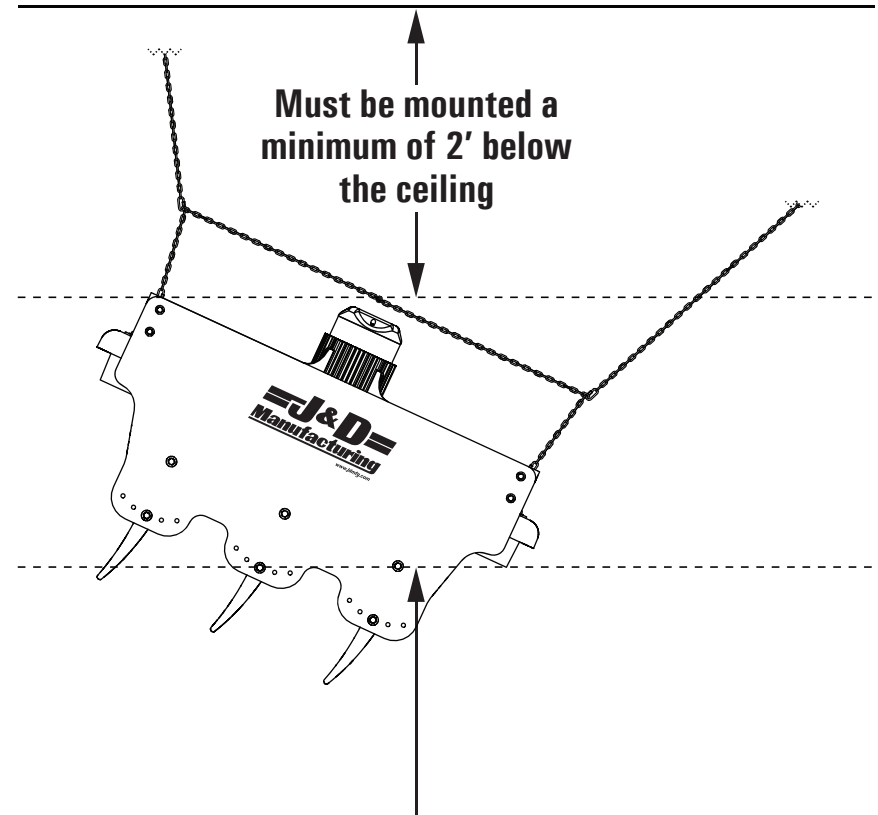

OSHA requires this fan to be mounted a minimum of 7' above the floor.

NOTE: Consideration of the height of frequently used machinery should be taken into account to avoid damage and inconvenience.

10

Hanging Recommendations with Stabilizing Chain Harness:

- Take into account recommendations from Steps 10 and the below recommended angles of the fan.
- Hang fan.
- Attach each hanging chain end (not provided) to the Stabilizing Chain Harness using the previously placed quick links from Step 9.
- Secure by fully closing each quick link by rotating the barrel as shown in Step 8.

NOTE: To ensure fan does not distort or twist, fan must be hung evenly and level from side to side, as shown below. If not hung correctly fan distortion may cause blade to hit venturi edge, damaging venturi and blade and will NOT BE COVERED BY WARRANTY.

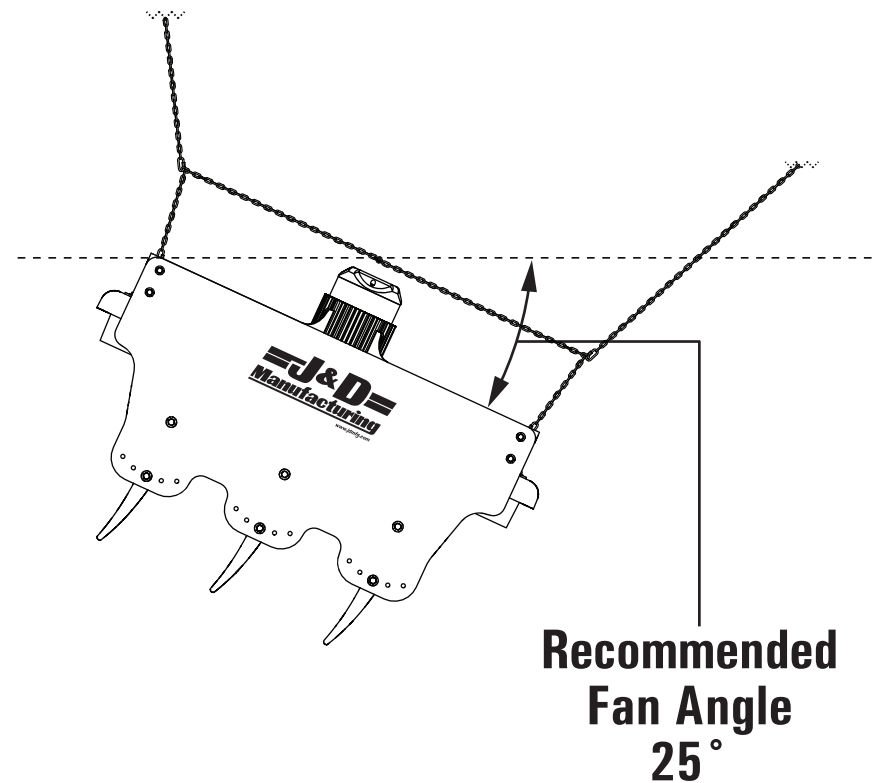
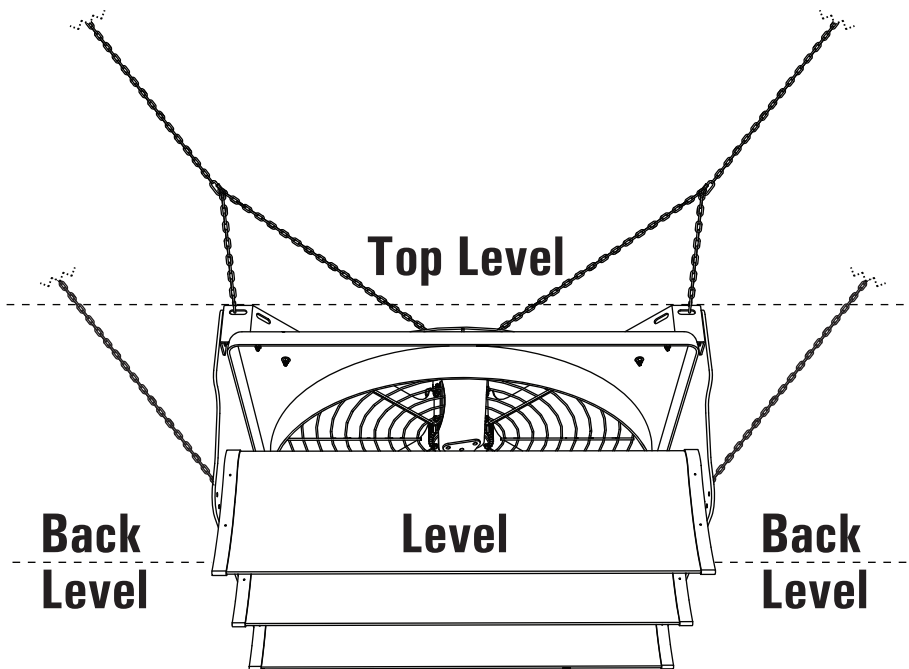

11

Once fan is securely installed proceed to Page 10.



DISCONNECT POWER BEFORE INSTALLING OR SERVICING.



ALL ELECTRICAL WORK IS TO BE COMPLETED BY A LICENSED AND CERTIFIED ELECTRICIAN AND MEET NATIONAL (NEC), REGIONAL AND LOCAL ELECTRIC CODES.

IT IS THE RESPONSIBILITY OF THE CUSTOMER TO ENSURE THAT INSTALLATIONS MEET THIS AND ANY ADDITIONAL PROVIDED ELECTRICAL REQUIREMENTS.

J&D Manufacturing is not liable for issues arising from non-compliant wiring or installation by unqualified personnel.

Maintenance Instructions:

- Disconnect power before cleaning or maintaining your fan in order to prevent serious injury or death.
- Service and repair of fan should only be completed by a qualified technician.
- For maximum efficiency and fan life, keep the following free from dirt and dust:
 - blades
 - louvers
 - motor
 - guard
- The totally enclosed air over motor has sealed ball bearings and does not require additional oil.

General Wiring Instructions:

- Wiring should only be performed by a trained electrician to prevent injury or death.
- Failure to follow the mentioned recommendations can lead to stray voltage and/or increased electrical interference.
- Only permit power to unit when guards are properly installed to prevent injury.
- Refer to motor/VFD specific instructions included with motor/VFD.
- Install manual disconnect switch inside building adjacent to fan.
- Route wire to motor with drip loop and secure. Drip loop will drain accumulated moisture away from the motor.
- Use four conductor 26AWG (or heavier), shielded, dual twisted pair, signal wire with drain wire from J&D control to motor/VFD.

Apply the following as applicable to this unit.

Fans using a VFD:

- Use line reactors to minimize voltage spikes and harmonics.
- Use VFD-rated shielded cable between the drive and motor.
- Ground the shield wire only at the VFD end to avoid ground loops.
- Follow the VFD's wiring instructions and nameplate ratings.
- All equipment must be wired to meet IEEE 519-2022 standard for harmonic distortion.
- Use dedicated overcurrent and overload protection (motor circuit breaker) for each fan.
- Input power must be within +/-5% of nominal voltage.

Single Phase Fans using an Electronic Voltage Control (i.e. TRIAC):

- Do not reduce voltage below 40% of the motor's rated voltage.
- This control method may cause motor humming.
- Fan speed may fluctuate and not remain consistent.

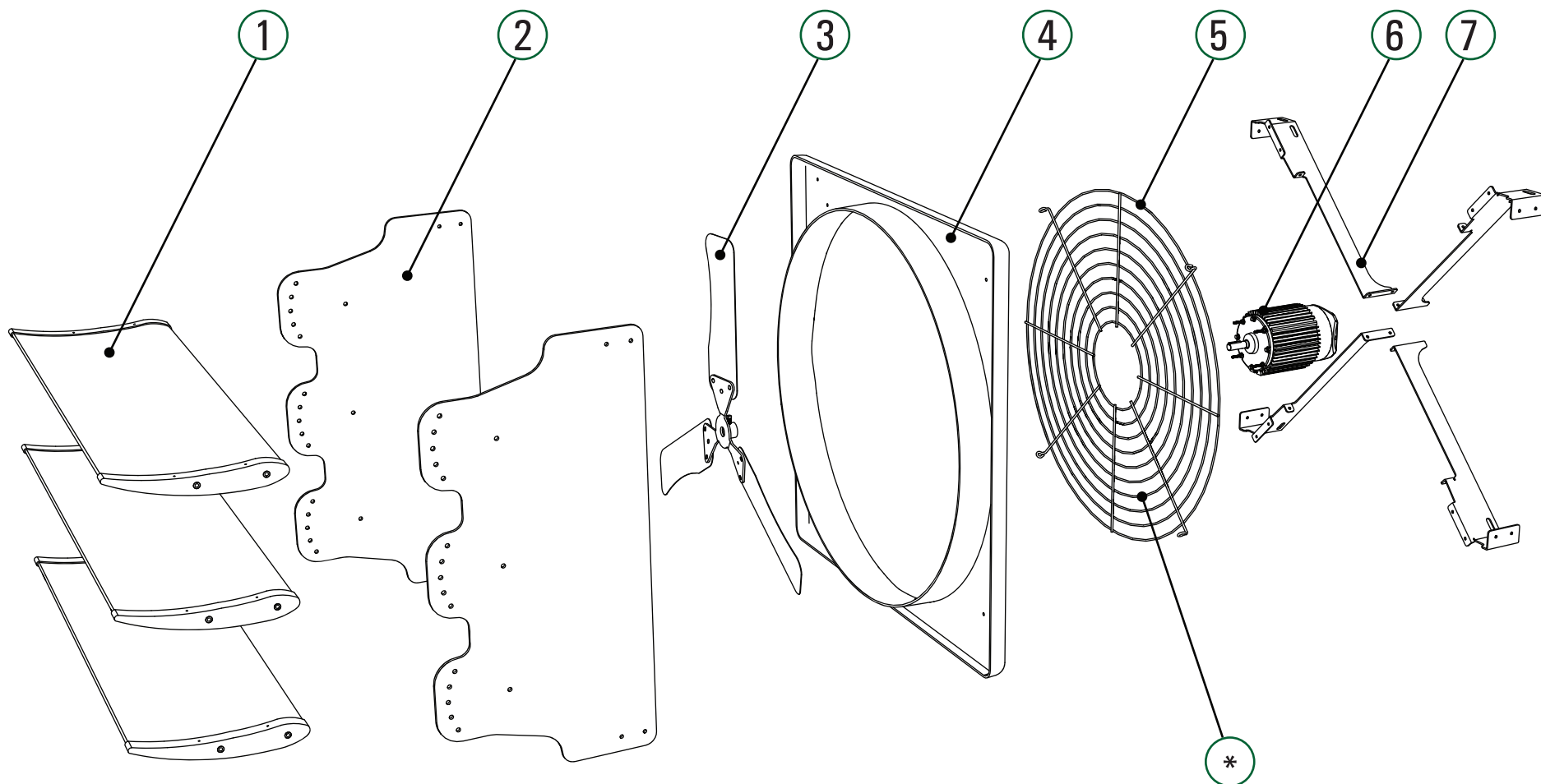

#	(Qty) Description
1	(3) Louvers
2	(2) Louver Guides
3	(1) Prop

#	(Qty) Description
4	(1) Venturi
5	(1) Guard
6	(1) Motor

#	(Qty) Description
7	(4) Motor Mount Brackets

*Not included on the non-guarded model.