

## Installation Instruction Sheet

---

# SportPro Synthetic Rail Blades

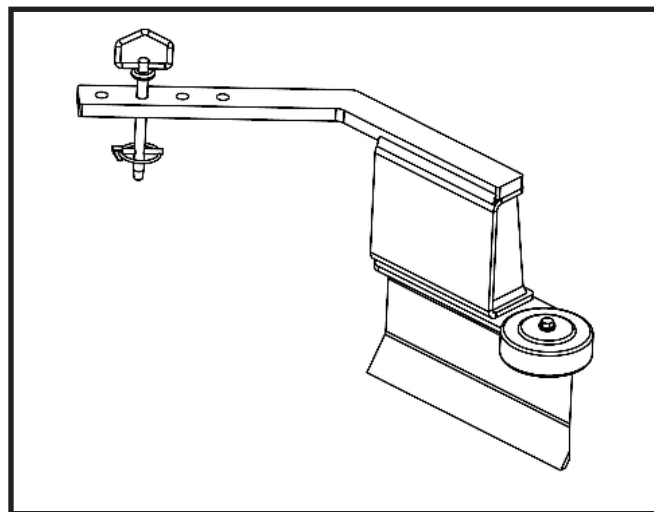
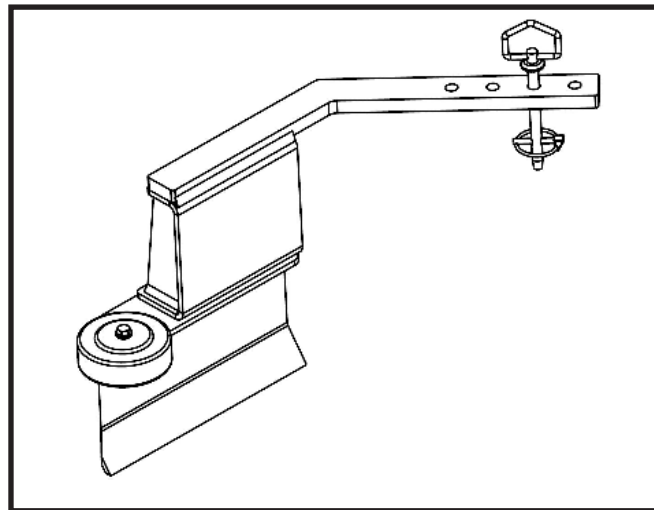

**NOTE:** This Owner's Manual covers several models. Features may vary by model. Not all features in this manual are applicable to all models and the model depicted may differ from yours.

## 10-90673 KIT: RAIL BLADE RIGHT: SYNTHETIC

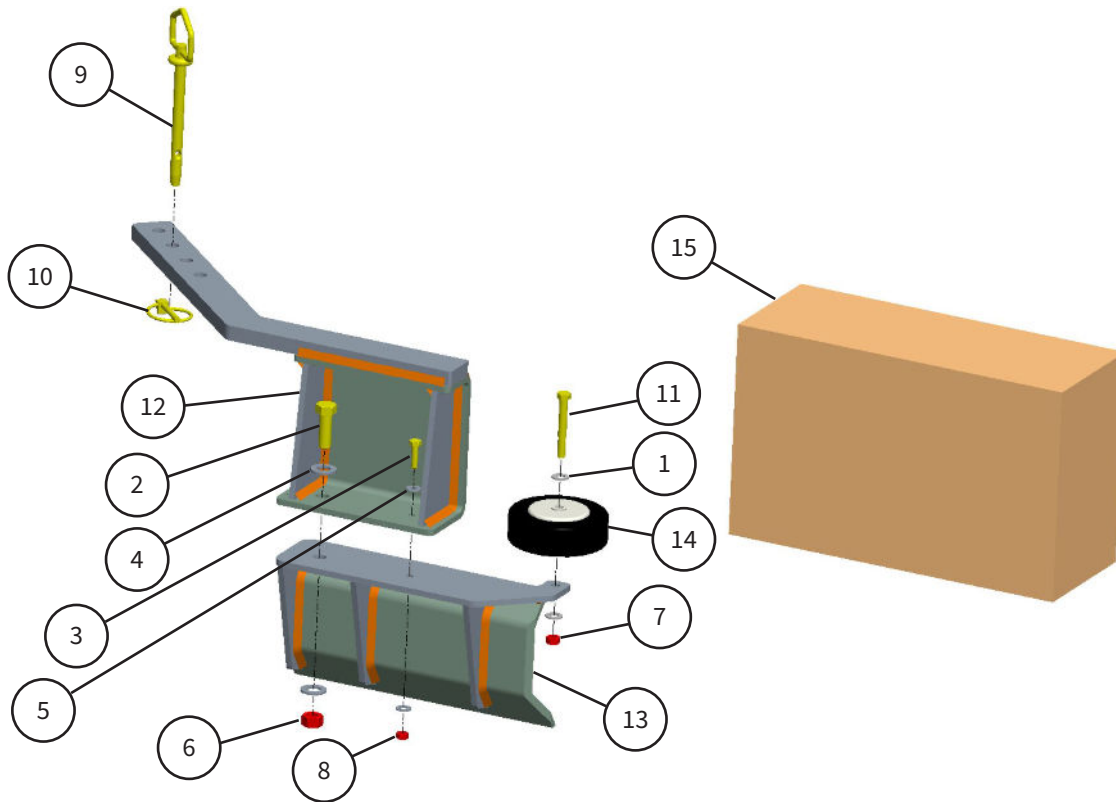

ITEM	PART #	DESCRIPTION
1	10-20128	5/16 SAE WASHER ZNC
2	10-20164	HX HD BOLT:1/2-13 1.5":ZINC GR5
3	10-20175	HX HD BOLT:1/4-20 1":ZINC GR5
4	10-20194	FLT WSHR:1/2 SAE: CL ZINC
5	10-20196	FLT WSHR:1/4 SAE:CL ZINC
6	10-20201	NYLOCK NUT:1/2-13:ZINC GR 5
7	10-20202	NYLOCK NUT:5/16-18:ZINC GR 5
8	10-20208	NYLOCK NUT:1/4-20:ZINC GR 5
9	10-20230	HITCH PIN:1/2" X 5":ZINC
10	10-20232	LYNCH PIN:1/4"X1.25":ZINC
11	10-20368	HX HD BOLT:5/16-18 2.50":ZINC GR5
12	10-40739	WLDMT: RH RAIL BLADE UPPER: SYNTH
13	10-40740	WLDMT: RH BLADE
14	10-60069	WHEEL: RAIL BLADE: TR3E RASCAL
15	10-80027	50 Tip box 14-7/16 x 5-5/8 x 8-7/8 5PF 44#C Plain

## 10-90673 KIT: RAIL BLADE LEFT: SYNTHETIC

Slides into the end of the center tube on either the Scarifier tube assembly (shown) or S-Tine tube assembly. Insert pin thru hole in tube assembly then thru desired hole (4 choices) in Rail Blade Bracket then thru bottom hole in tube assembly. Attach Lynch Pin thru hole in Pin to secure to tube assembly.

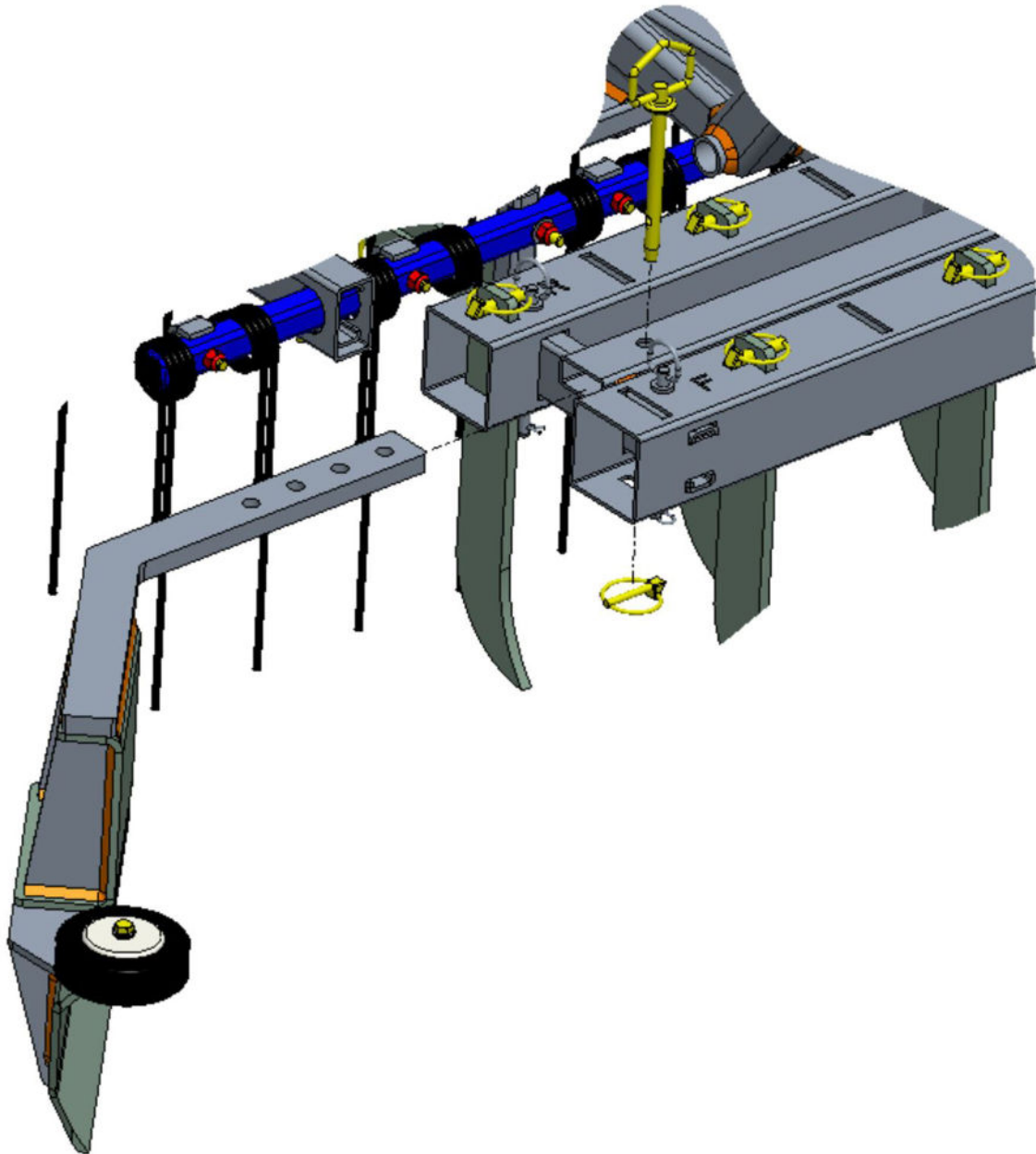

## 10-90674 KIT: RAIL BLADE LEFT: SYNTHETIC

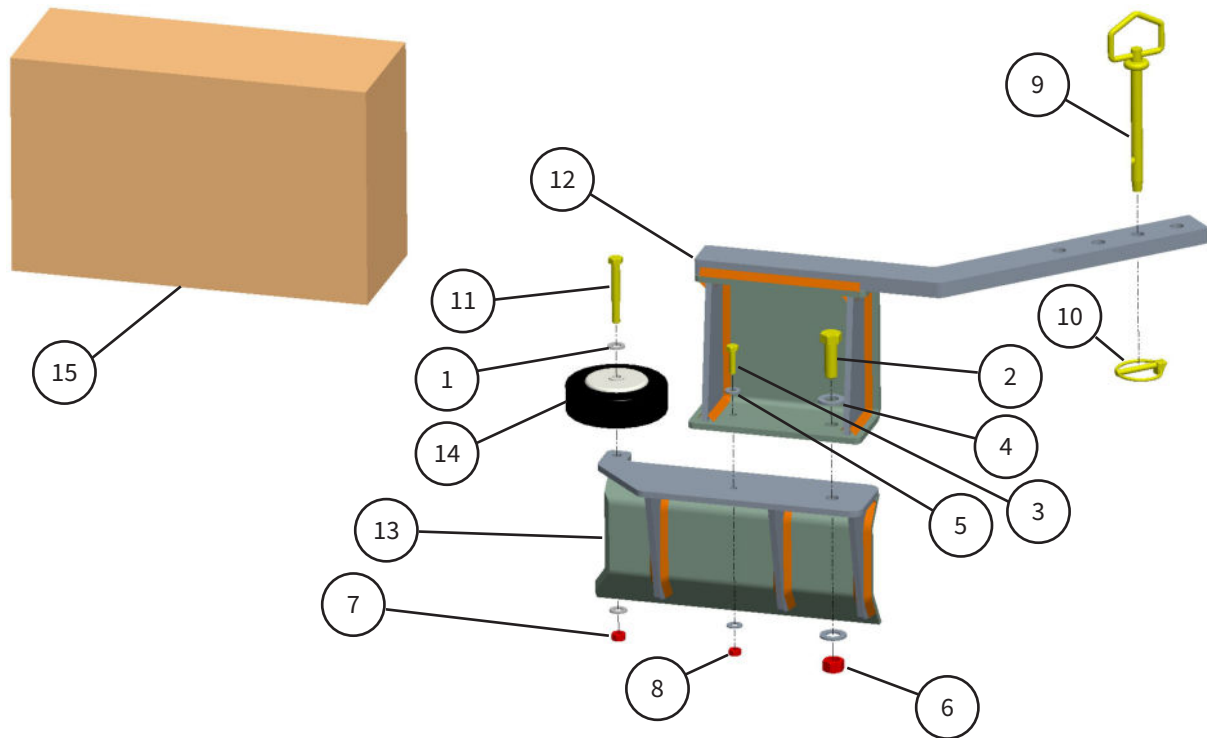

ITEM	PART #	DESCRIPTION
1	10-20128	5/16 SAE WASHER ZNC
2	10-20164	HX HD BOLT:1/2-13 1.5":ZINC GR5
3	10-20175	HX HD BOLT:1/4-20 1":ZINC GR5
4	10-20194	FLT WSHR:1/2 SAE: CL ZINC
5	10-20196	FLT WSHR:1/4 SAE:CL ZINC
6	10-20201	NYLOCK NUT:1/2-13:ZINC GR 5
7	10-20202	NYLOCK NUT:5/16-18:ZINC GR 5
8	10-20208	NYLOCK NUT:1/4-20:ZINC GR 5
9	10-20230	HITCH PIN:1/2" X 5":ZINC
10	10-20232	LYNCH PIN:1/4"X1.25":ZINC
11	10-20368	HX HD BOLT:5/16-18 2.50":ZINC GR5
12	10-40741	WLDMT: LH RAIL BLADE UPPER: SYNTH
13	10-40742	WLDMT: LH BLADE
14	10-60069	WHEEL: RAIL BLADE: TR3E RASCAL
15	10-80027	50 Tip box 14-7/16 x 5-5/8 x 8-7/8 5PF 44#C Plain

## 10-90674 KIT: RAIL BLADE RIGHT: SYNTHETIC

Slides into the end of the center tube on either the Scarifier tube assembly (shown) or S-Tine tube assembly. Insert pin thru hole in tube assembly then thru desired hole (4 choices) in Rail Blade Bracket then thru bottom hole in tube assembly. Attach Lynch Pin thru hole in Pin to secure to tube assembly.

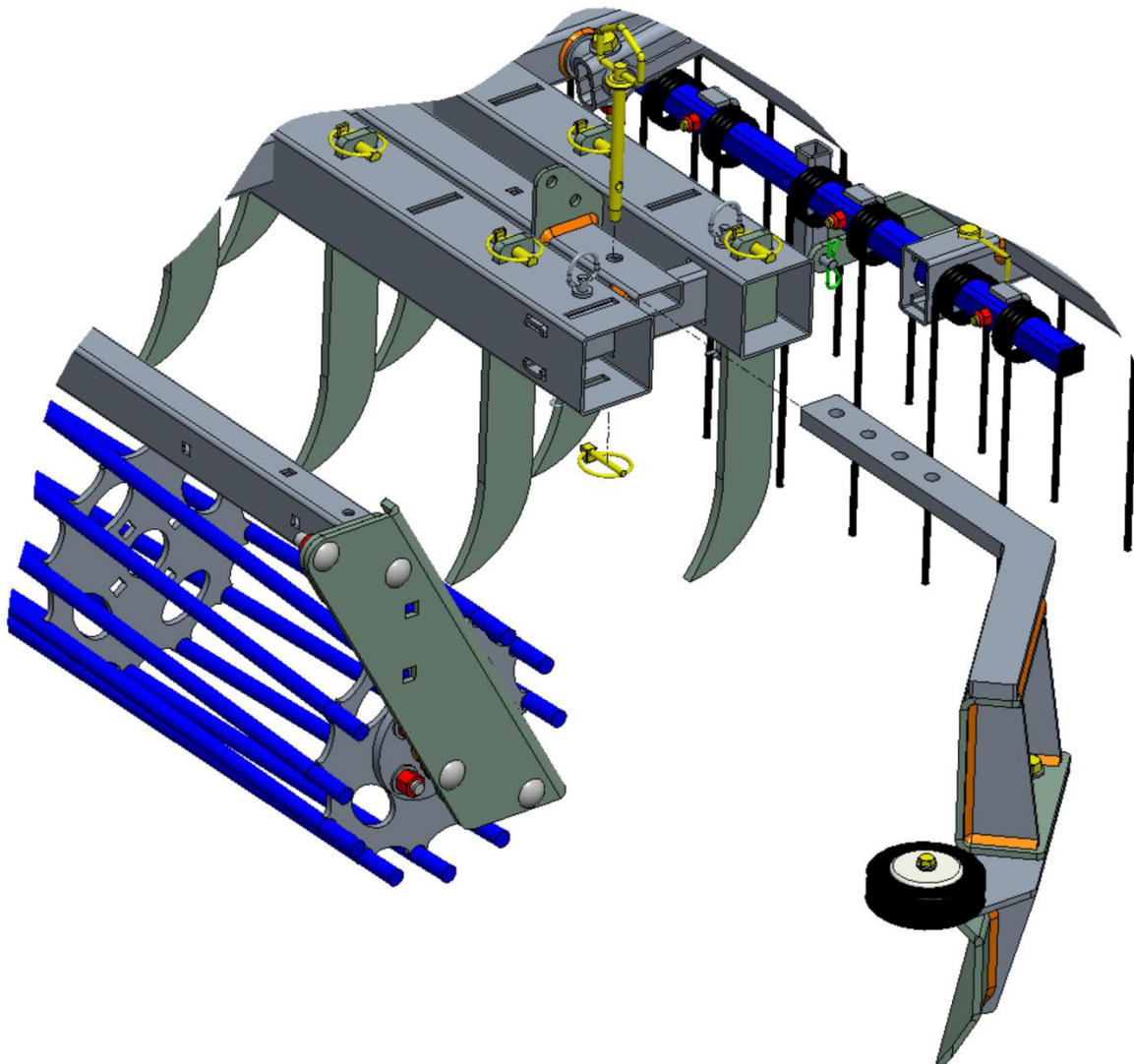

## Contact Information

ABI Attachments, Inc  
520 S. Byrkit Ave.  
Mishawaka, IN 46544

## Customer Support

Email: [support@abiattachments.com](mailto:support@abiattachments.com)  
Phone: 877-788-7253  
Website: [www.abisupport.com](http://www.abisupport.com)

To order parts or to speak to one of ABI's Customer Service Representatives contact us Monday to Friday 9am to 5pm EST.

The setup video for operation is available at [abisupport.com](http://abisupport.com) under Synthetic Footing Arena Drags.

For additional information on the use or setup of the SportPro Synthetic Arena Drags, please contact the ABI customer support team at 855.211.0598.

**Additional support videos** are available at the ABI support page ( [abisupport.com](http://abisupport.com) ) under each tool.

**Warranty Information and Return Policy** - Warranty and return policy information can also be found on the ABI support page under each tool. For additional questions regarding warranty or return policy, contact the ABI customer support team at 855.211.0598.

