

## Installation Instruction Sheet

# SportPro Synthetic Rail Wheel

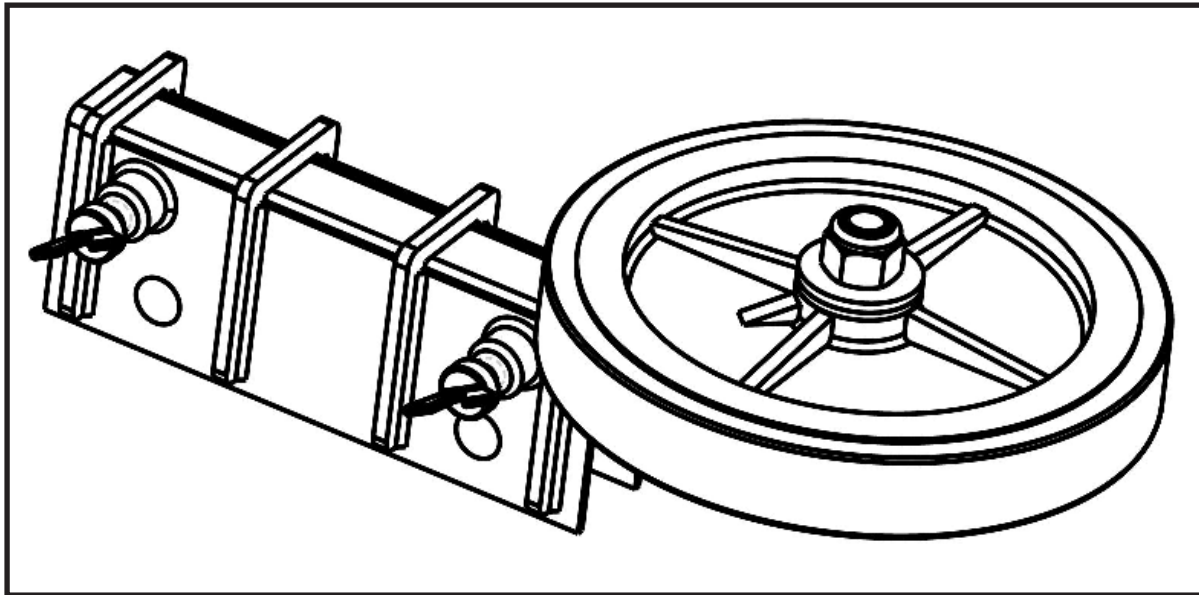

**NOTE:** This Owner's Manual covers several models. Features may vary by model. Not all features in this manual are applicable to all models and the model depicted may differ from yours.

## 10-90638 RAIL WHEEL OPTION

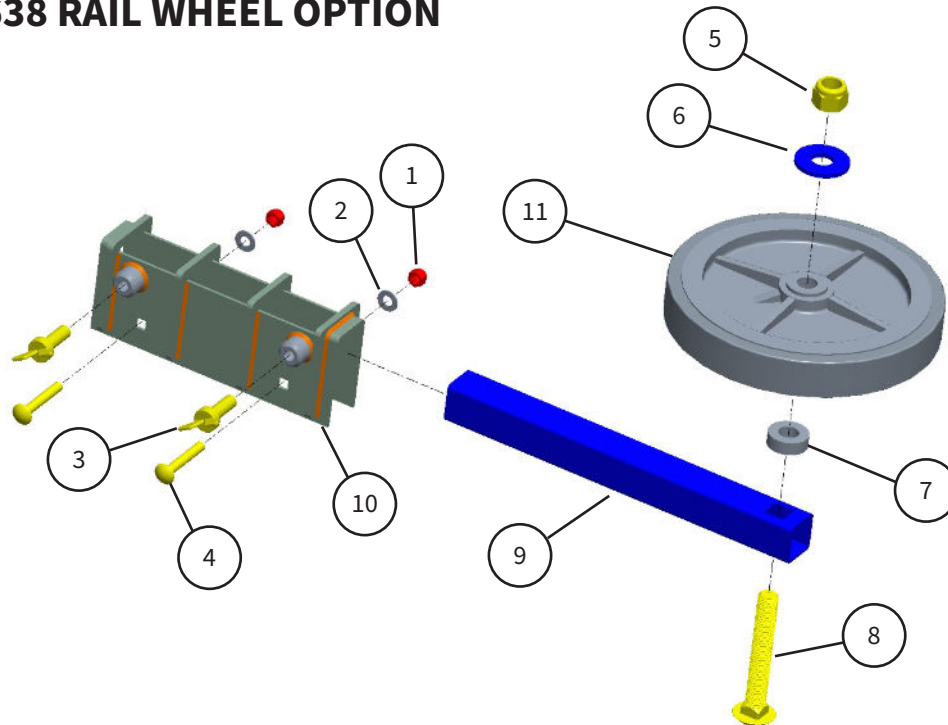

ITEM	PART #	DESCRIPTION
1	10-20055	NYLOCK NUT:3/8-16:ZINC GR5
2	10-20195	FLT WSHR:3/8 SAE:CL ZINC
3	10-20256	WING BOLT:1/2"-13 X 1.5:ZINC GR5
4	10-20330	CARR BOLT:3/8-16 2.5":ZINC GR5
5	10-20344	NYLOCK NUT:3/4-10 :ZINC GR5
6	10-20506	3/4" USS WASHER: 2" O.D.
7	10-20564	SPACER: STEEL: 3/4" I.D. X 1-1/2" O.D. X 1/2" LONG
8	10-20571	CARR BOLT: 3/4-10 X 5":ZINC GR5
9	10-32633	TUBE: 6.5 S TINE : SYNTH
10	10-40744	WLDMT: RAIL WHEEL BRACKET: SYNTH
11	10-60102	WHEEL: 10" X 1.5" GREY TPR: 3/4 HUB

## 10-90638 RAIL WHEEL OPTION

Slides over the front Roller tube until the 2 holes in the Rail Wheel Bracket line up with the 2 holes in the Roller tube. Insert 3/8-16 x 2-1/2" long carriage head bolt into each hole of the bracket and tube. Slide (1) 3/8" Flat Washer onto each bolt then thread (1) 3/8-16 Nylock Nut onto each bolt and tighten with 9/16" socket set (or wrench).

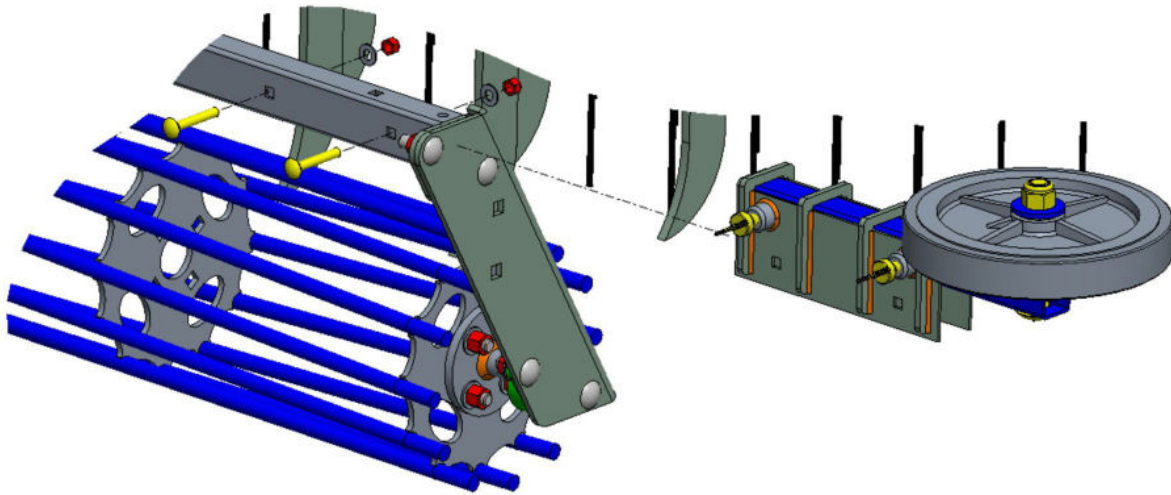

## Contact Information

ABI Attachments, Inc  
520 S. Byrkit Ave.  
Mishawaka, IN 46544

## Customer Support

Email: [support@abiattachments.com](mailto:support@abiattachments.com)  
Phone: 877-788-7253  
Website: [www.abisupport.com](http://www.abisupport.com)

To order parts or to speak to one of ABI's Customer Service Representatives contact us Monday to Friday 9am to 5pm EST.

The setup video for operation is available at [abisupport.com](http://abisupport.com) under Synthetic Footing Arena Drags.

For additional information on the use or setup of the SportPro Synthetic Arena Drags, please contact the ABI customer support team at 855.211.0598.

**Additional support videos** are available at the ABI support page ( [abisupport.com](http://abisupport.com) ) under each tool.

**Warranty Information and Return Policy** - Warranty and return policy information can also be found on the ABI support page under each tool. For additional questions regarding warranty or return policy, contact the ABI customer support team at 855.211.0598.

